

INJECTION VALVE 3/4"

ACC053

TECHNICAL FEATURES

Max. flow: 500 l/h

Connection thread: 3/4"

Opening pressure: 0,5 bar

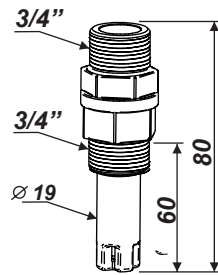

	PP	INOX	PVDF
BODY	PP	AISI316	PVDF
BALL	Glass	AISI316	Borosilicate
O-RING	FPM	FPM	FPM
SPRING	AISI316	AISI316	AISI316

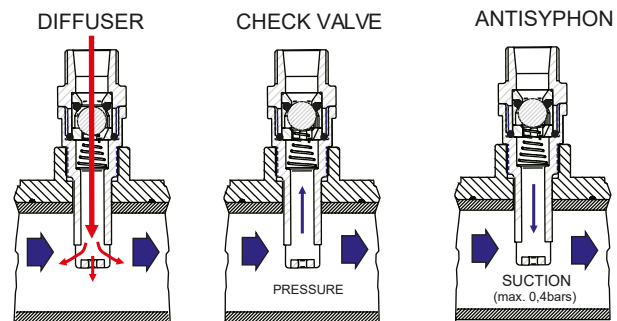
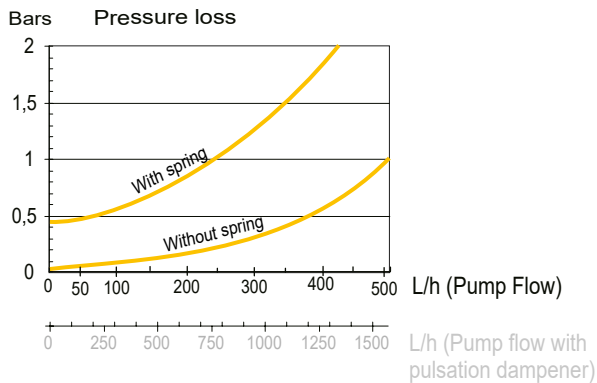

INJECTION VALVE 3/4"

PP *62-832-P (with spring)
62-833-P (without spring)

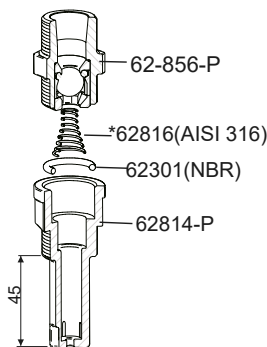

PVDF *62-808-F (with spring)
62-809-F (without spring)

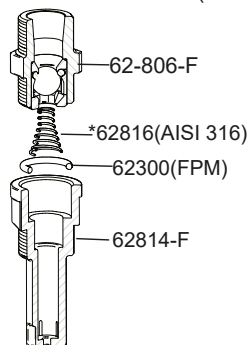

AISI 316 *62-808-I (with spring)
62-809-I (without spring)

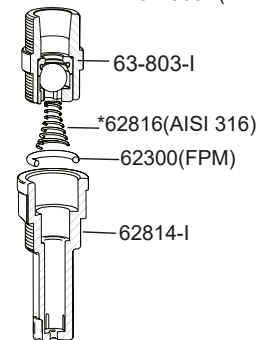

INJECTION VALVE 3/4" LONG 108mm

PP *62-835-P (with spring)
62-836-P (without spring)

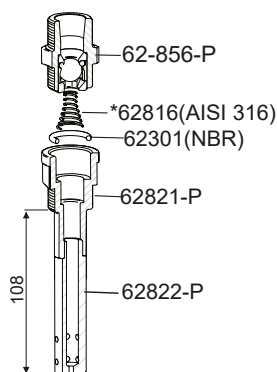

PVDF *62-818-F (with spring)
62-819-F (without spring)

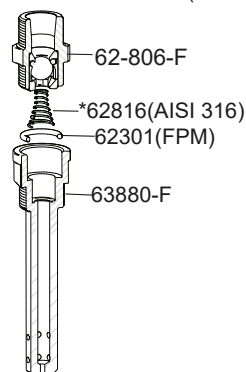

AISI 316 *62-818-I (with spring)
62-819-I (without spring)

